

HOW TO OPERATE THE AM SERIES

- Release the Sidelock on either side of the sign by pushing from the bottom side of the Sidelock in an upward motion.
- Remove the Sidelock
- Slide the Insert out and off the Base Plate.
- Replace with a new insert by sliding it onto the Base Plate.
- Replace the Sidelock in a downward motion securing the contents of the sign.

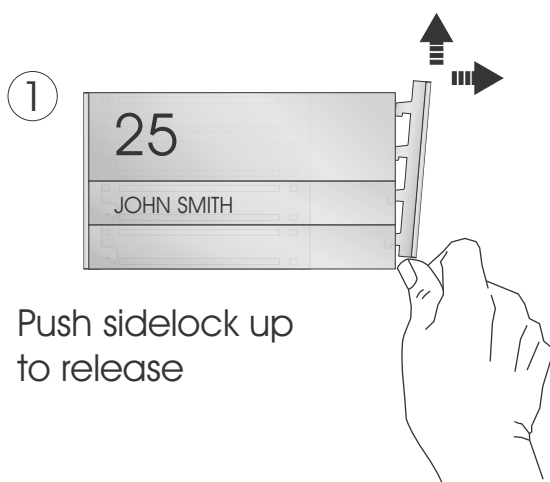
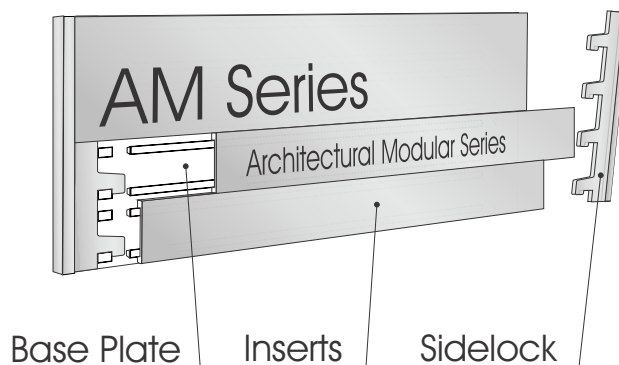

Push sidelock up to release

All AM Series signs have 3 parts, regardless of size or layout.

Follow the 4 steps illustrated here. This applies to all AM Series Signs.

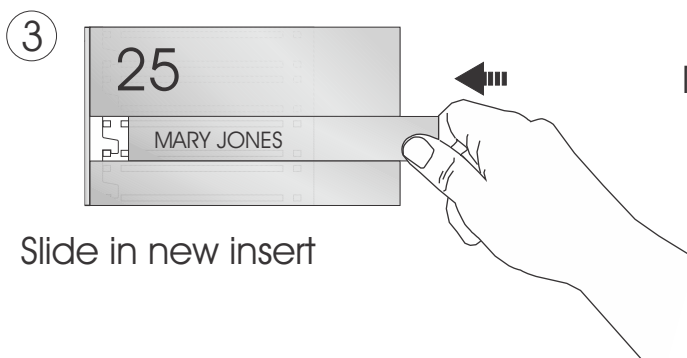

Slide in new insert

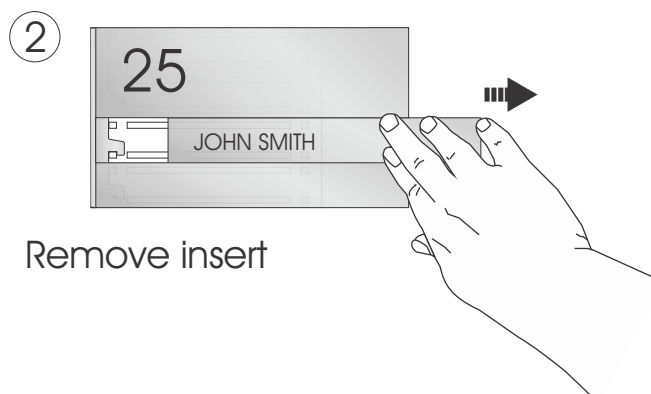

Remove insert

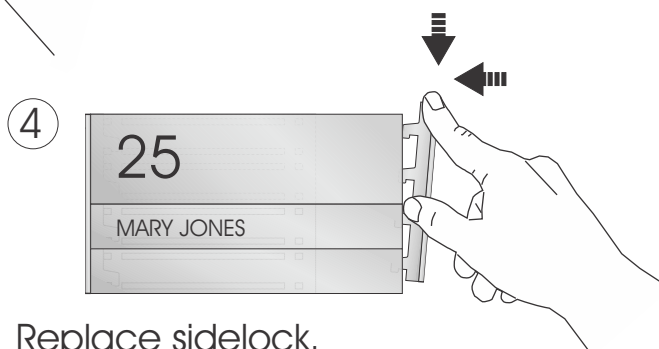

Replace sidelock.