

## How to Operate and Change Inserts

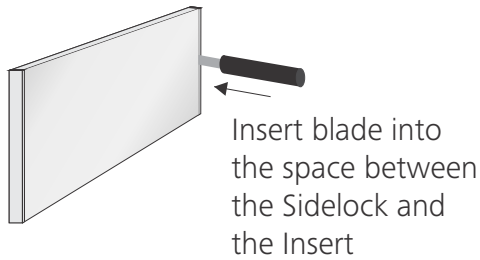

1. Simply slide the steel blade on the Custom Insert Removal Tool into the gap between the Frame and the Insert or Panel.

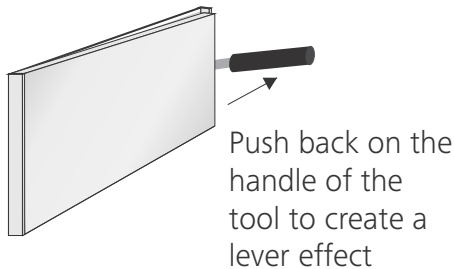

2. Once the blade is inserted, push down on the handle of the tool, creating a lever effect.

The Insert / Panel will release from the backing panel. Simply take hold of the Insert and remove.

To replace the Insert or Panel just slip it back into position within the frame.

The Process is the same for both the 2 Sided and 4 Sided Frame options.

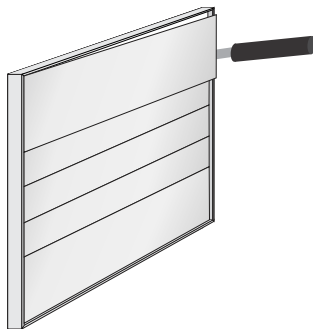

3. Repeat the same process for signs with multiple Inserts (Extruded Aluminium) or Aluminium Panels.

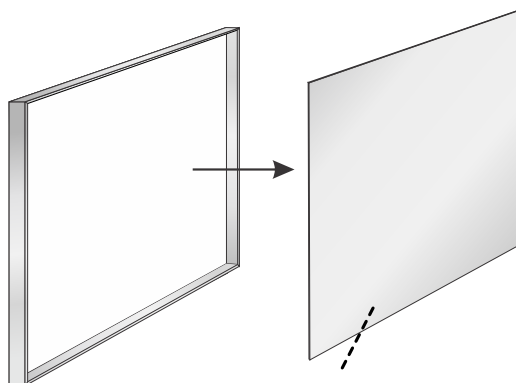

Front Opening Unit →

Remove Aluminium Insert or Panel with The Custom Removal Tool or a Suction Cup

Aluminium Panel (Plate) or Insert (Extruded Insert)

Please contact S2K Identity Systems with any questions