

# HOW IT OPERATES

## Architectural Modular Series

### SIGNS WITH STANDARD SPRING CLIPS

(Standard Option on all complete Signs)

Sidelocks are marked (L) Left and (R) Right. Install with hooks facing down.

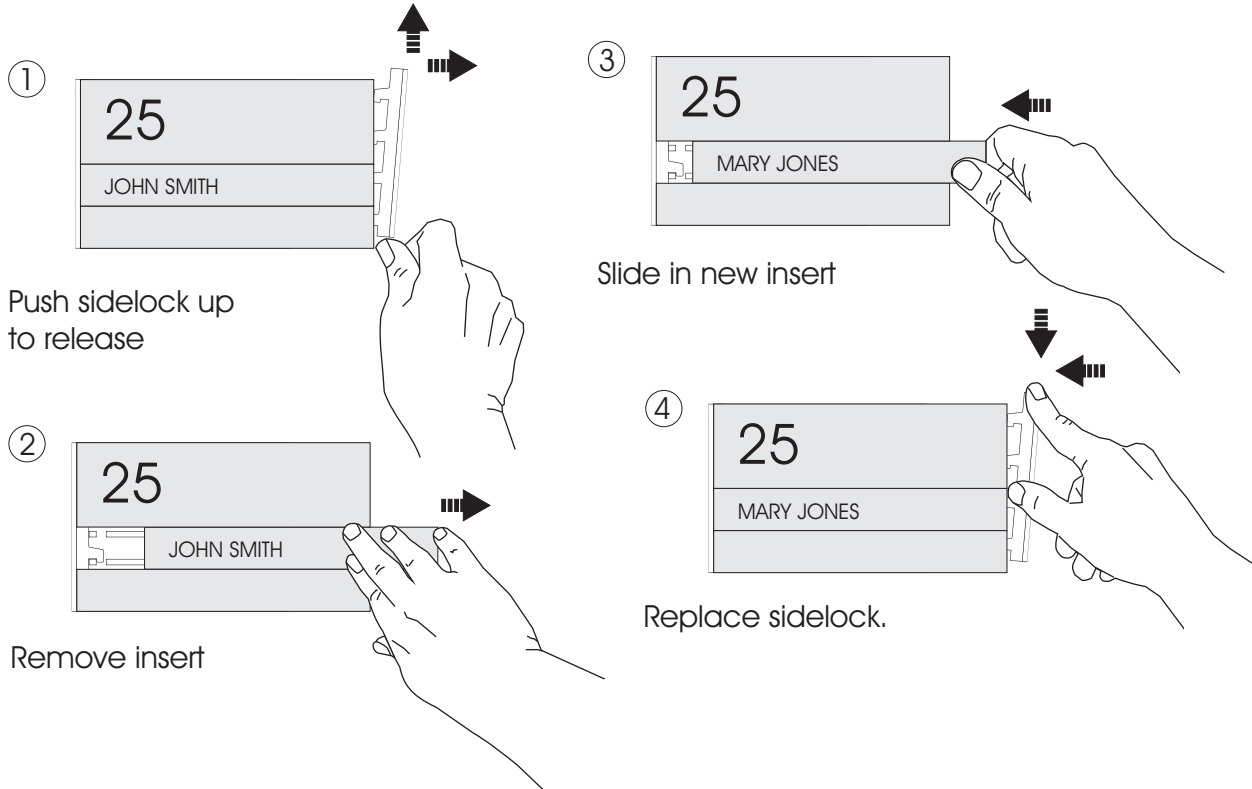

### SIGNS WITH TAMPER PROOF LOCK CLIPS

(Non- standard option, must be specified if required)

With the tamper proof version, removal & re-installation of sidelocks is the same as per signs with standard clips with the addition of a tool to unlock the mechanism.

